



Vanillaplan®



# Who is Vanillaplan?

Startup from Basel, digitization of the magnetic board

Since 2017 software development

Since 2019 on market

Since 2021 interface platform Vanillaplan fair

Since 2022 production scheduling

In development: time capturing







## Challenges in the construction industry

### Project work:

- Increasing complexity of construction projects
- Shortage of skilled workers
- High volatility (delays, changes, weather)
- Low margins
- Increasing government regulations
- High fluctuations in workforce demand
- Complexity increases with company size

A small orange icon of a hammer, positioned to the left of the main title.

## Why construction software?

**Resource planning is a niche, but also a market gap**

- typically neglected in ERP / construction software
- excel sheets inflexible and hard to maintain
- digitalization gap in construction



Baustelle	KW 34 6-10-15	Montag	Dienstag	Mittwoch	Donnerstag	Freitag
Lölliger Paul, Münchenstein	2	3	2	2		
Tresana AG, Kloten			1			
Hertel Cornelia, Bristlach	2	1	2	2		
Huber Straub, Riehen			1			
Mehrzweckhalle, Lupatzen	3	2	2	2	2	2
Sonnhalde, Neubau Werkshole					2	
PASS Hauswerk, Basel	2		2	2	1	2
Sonnhalde, Bäckerei						1
Goldschmidt Ivo, Liestal						
Kirchgemeinde, Hochwald	2	1	2			
Buess Willi, Sissach	2	2	2	2	2	2
	4	4	4	4	4	4
	4	4	4	4	4	4
	4	4	4	4	4	4
	4	4	4	4	4	4
	4	4	4	4	4	4





# Interfaces

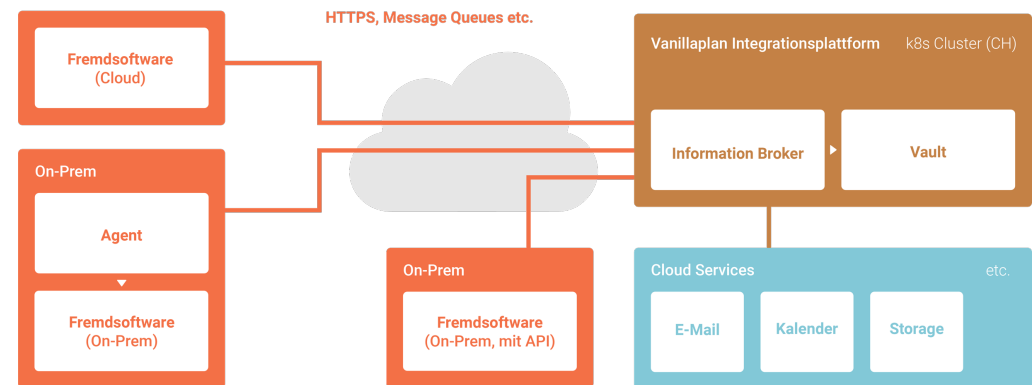

- Generic workflows can transfer data between any IT systems
- Fully automated, time schedule or event driven

**Arnold**  
Infra Services

**CKW.**

**EKZ** Eltop

**Selmoni**  
Selmoni

**ROSENMUND**  
Sanitär | Heizung | Lüftung | Kälte

**Luzi**  
Gerüste

**stamm**

**B 3**

**TECTON®**  
  
MACHT BAUTEN DICHT

**RENGGLI**  
HOLZBAU WEISE

 ClimatePartner

 swiss made  
software

**SBV**  
**SSE**  
**SSIC**

Gewerbeverband  
Basel-Stadt 

 DSGVO  
konform



A small icon of a hammer, positioned to the left of the section header.

## Current trends in construction tech

- BIM – Building Information Modeling
- Process improvements - Lean / agile / alliances
- Smart software - AI / ML / optimization
- Decarbonization – replace concrete by timber

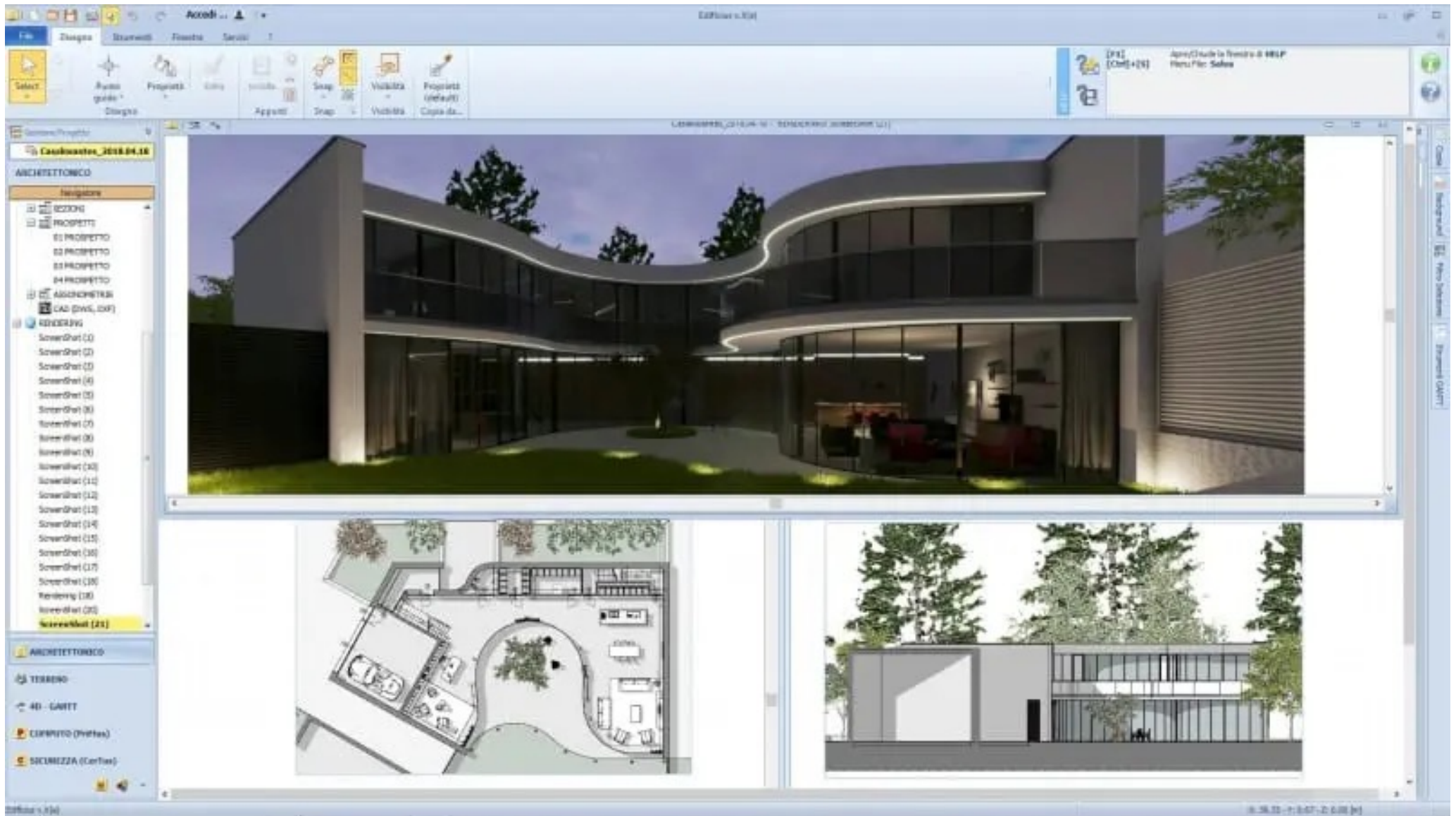

















## Where does the journey go?

- Time and activity recording
- Auto-scheduling for workforce and manufacturing
  - Machine learning
  - Nonlinear optimization
- Innosuisse project: co-creative project schedules
  - Realtime collaboration





**Thanks for your attention**

Questions?

